

Main Particulars		Tank Capacities	
LOA / Length BP	83 m / 61 m	Fresh Water	480 m ³
Beam	36 m	Fuel Oil	480 m ³
Depth	6 m	Ballast Water	890 m ³
Draft	5.5 m	Lube Oil	9 m ³
Variable Load	1600 t	Bilge Water	85 m ³
Leg Length	104 m	Brine	256 m ³
Water Depth	80 m	Dirty Oil	56 m ³

Fire and Gas Detection System		Communication Equipment	
Integrated Alarm System (IAS)	NES	VHF	2
Fire detection system	Integrated into IAS	SSB / Inmarsat	2 + 1
Gas detection system	Integrated into IAS	Aircraft Radio	1
H ₂ S sensors	16	GMDSS	2
CH ₄ sensors	16	VSAT	1

Propulsion and Generators		Accommodation	
Generator Sets	4 x 1600 kW	Single Ensuite	4
	Wartsila 8L20	Double Ensuite	27
Emer. Generators	480 kW	Four Berth Shared	23
	Volvo Penta	Total POB	104-150 depending on regional configuration
Thrusters	4 x 1200 kW	Hospital	1
Speed	8 Knots	Office Area	6 x 35 m ²
Water Maker	2 x 50 m ³ / day	Conference Room	1 x 70 m ²

Deck Equipment		Jacking System	
Main Crane		Pinions per chord	6
Main Hoist	400 t @ 9-16.8 m (7 falls)	Jacking drives per leg	18
	76 t @ 61 m	Speed	0.8m / min
Auxiliary Hoist	60 t @ 11.5-66 m (2 falls)	Effective lifting capacity per leg	1620 t
	30 t @ 66 m	Pre-Load holding capacity per leg	2754 t
	Man Riding mode 2 tons	Spudcan size	30 m ²
Auxiliary Crane	15 t @ 25 m		
Deck Space	1035 m ²		

Safety Equipment		Helideck	
Lifeboats	2 x 150 persons	D Value	22.2 m
Liferafts	12 x 25 persons	Aircraft	Sikorsky 61N + 92 N
Rescue Boat	6 persons	Design as per CAP 437	
CO ₂ System	Engine and Galley		
Sprinkler	All accommodation covered		

Gulf Marine Services



Middle East & SE Asia	Europe	Chartering and Commercial	Operations
Gulf Marine Services Mussafah Base P.O. Box 46046 Abu Dhabi, United Arab Emirates Ph: +971 2 5028888; Fax: +971 2 5553421 Email: gmsmena@gmsuae.com	Gulf Marine Services 36 Abercrombie Court, Prospect Road Arnhall Business Park, Westhill, Scotland AB32 6FE, United Kingdom Ph: +44 (0) 1224 737200; Fax: +44 (0) 1224 737239 Email: gmsuk@gmsuae.com	Mr. Mark Preston Commercial Director Ph: +971 2 5028810 Email: chartering@gmsuae.com	Mr. Dennis Jul Pedersen Chief Operating Officer Ph: +971 2 5028740 Email: operations@gmsuae.com

Specifications provided in good faith but without guarantee and are subjected to change without prior notice.

www.gmsuae.com

GMS ENTERPRISE - OIL & GAS

SELF-PROPELLED SELF-ELEVATING ACCOMMODATION JACKUP BARGE



Operator

Gulf Marine Services

Class

A1, Self-Elevating Unit + AMS + ACCU + DP2

Builders

Gulf Marine Services Abu Dhabi

Year of Build

2013



ENTERPRISE - OIL & GAS

SELF-PROPELLED SELF-ELEVATING ACCOMMODATION JACKUP BARGE

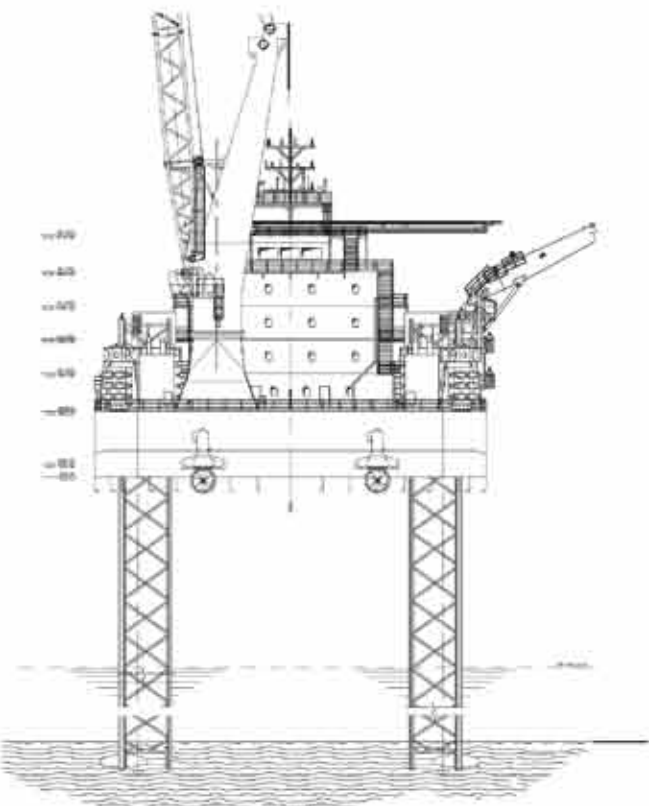

AFTVIEW

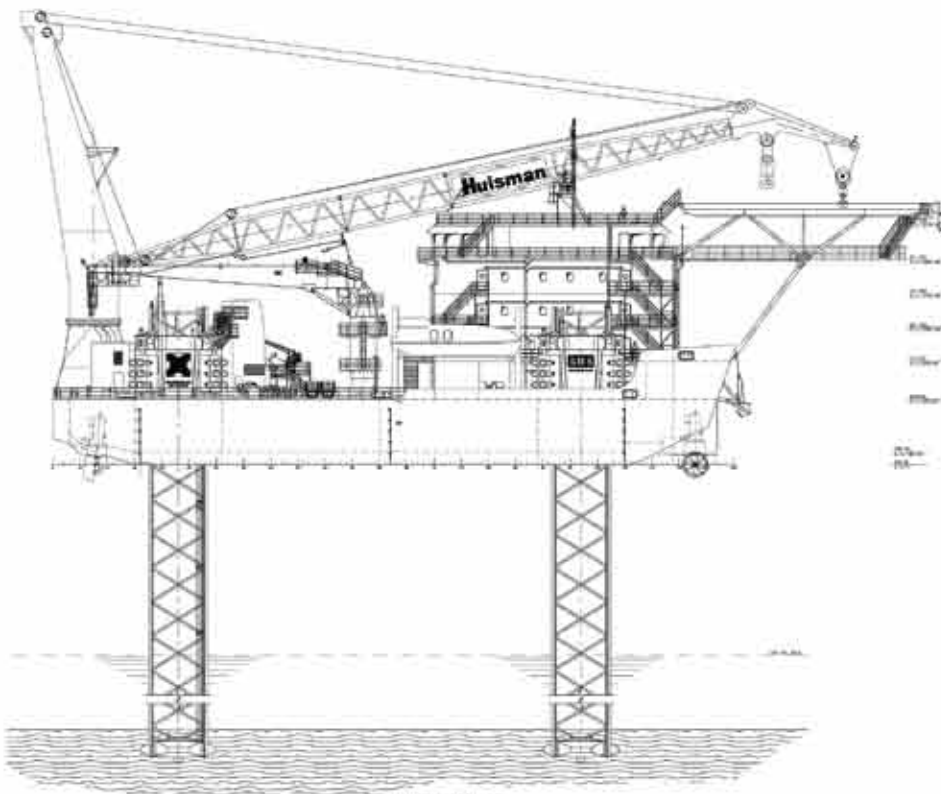

OUTBOARDPROFILE

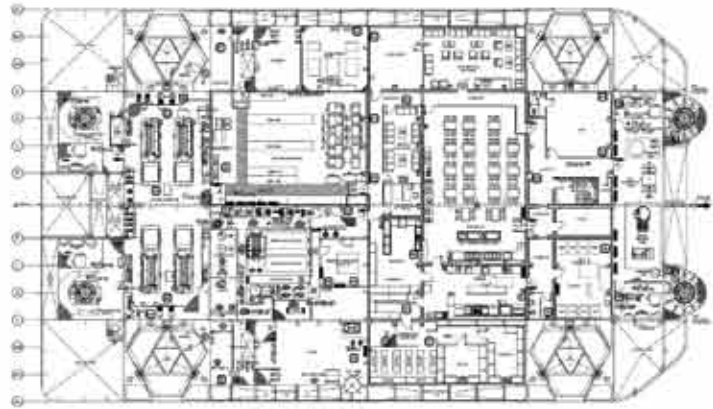

MACHINERYDECK

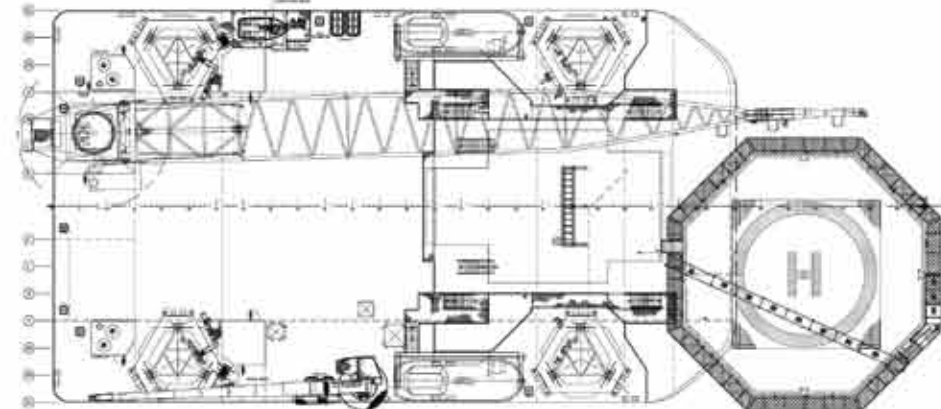

TOPVIEW

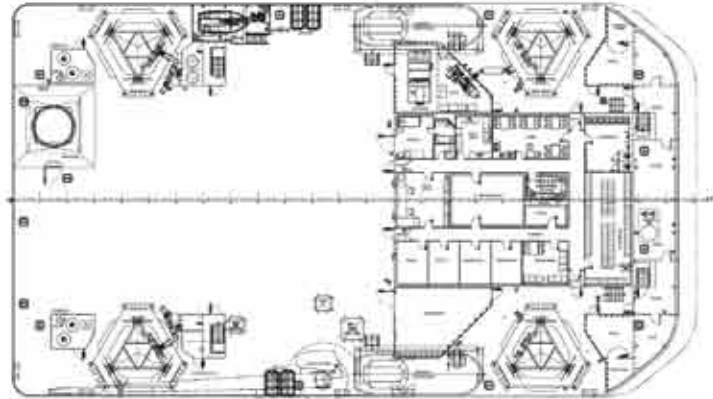

MAINDECK

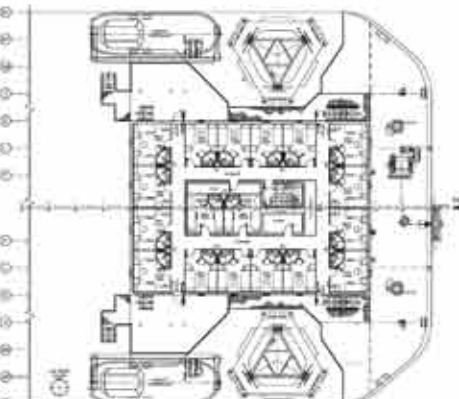

1#LEVEL



2#LEVEL



3#LEVEL



4#LEVEL

