

Main Particulars		Tank Capacities	
LOA / Length BP	76 m / 61 m	Fresh Water	480 m³
Beam	36 m	Fuel Oil	450 m³
Depth	6 m	Ballast Water	950 m³
Draft	5.95 m	Lube Oil	9 m³
Variable Load	1600 t	Sludge	5 m³
Leg Length	94.2 m	Brine	200 m³
Water Depth	65 m	Dirty Oil	10 m³

Fire and Gas Detection System		Communication Equipment	
Integrated Alarm System (IAS)	Wartsilla	VHF	1
Fire detection system	Integrated into Wartsilla IAS	SSB / Inmarsat	2 + 1
Gas detection system	Integrated into Wartsilla IAS	Aircraft Radio	1
H ₂ S sensors	16	GMDSS	1
CH ₄ sensors	16	VSAT	1

Propulsion and Generators		Accommodation	
Generator Sets	4 x 1500 kW Wartsila 8L20	Single Ensuite	8
Emer. Generators	480 kW Volvo Penta	Double Ensuite	49
Thrusters	4 x 1200 kW	Total POB	106-142 depending on regional configuration
Speed	8 Knots	Hospital	1
DP2 System	Kongsberg	Office Area	6 x 35 m²
Water Maker	2 x 50 m³/ day	Conference Room	1 x 70 m²

Deck Equipment		Jacking System	
Main Crane		Pinions per chord	6
Main Hoist	300 t @ 7.5-16.1 m (9 falls) 72 t @ 49.5 m	Jacking drives per leg	18
Auxiliary Hoist	30 t @ 9.2-53.4 m (single fall) Man Riding mode 2 tons	Speed	0.8m / min
Auxiliary Crane	15 t @ 25 m	Effective lifting capacity per leg	1494 t
Deck Space	1035 m²	Pre-Load holding capacity per leg	2754 t

Safety Equipment		Helideck	
Lifeboats	2 x 150 persons	D Value	19.5 m
Liferafts	12 x 25 persons	Aircraft	Super Puma AS332L2
Rescue Boat	6 persons	Design as per CAP 437	
CO ₂ System	Engine and Galley		
Sprinkler	All accommodation covered		

Specifications provided in good faith but without guarantee and are subjected to change without prior notice. **Rev.2**



Gulf Marine Services - UAE

Mussafah Base
P.O. Box 46046
Abu Dhabi, United Arab Emirates
Ph: +971 2 5559430; Fax: +971 2 5553421
Email: gmsauh@eim.ae

Gulf Marine Services - UK

36 Abercrombie Court, Prospect Road
Arnhall Business Park, Westhill, Scotland
AB32 6FE, United Kingdom
Ph: +44 (0) 1224 737200; Fax: +44 (0) 1224 737239
Email: gmsuk@gmsuae.com

Chartering and Commercial

Mr. Mark Preston
Commercial Director
Ph: +971 2 5028821
Email: chartering@gmsuae.com

Operations

Capt. Ron McGuire
Operations Director
Ph: +971 2 5028740
Email: operations@gmsuae.com

GMS ENDURANCE - OIL & GAS

SELF-PROPELLED SELF-ELEVATING ACCOMMODATION JACKUP BARGE



Operator

Gulf Marine Services W.L.L.

Class

A1, Self-Elevating Unit + AMS + ACCU + DP2

Builders

Gulf Marine Services W.L.L. Abu Dhabi

Year of Build

2010



ENDURANCE - OIL & GAS

SELF-PROPELLED SELF-ELEVATING ACCOMMODATION JACKUP BARGE

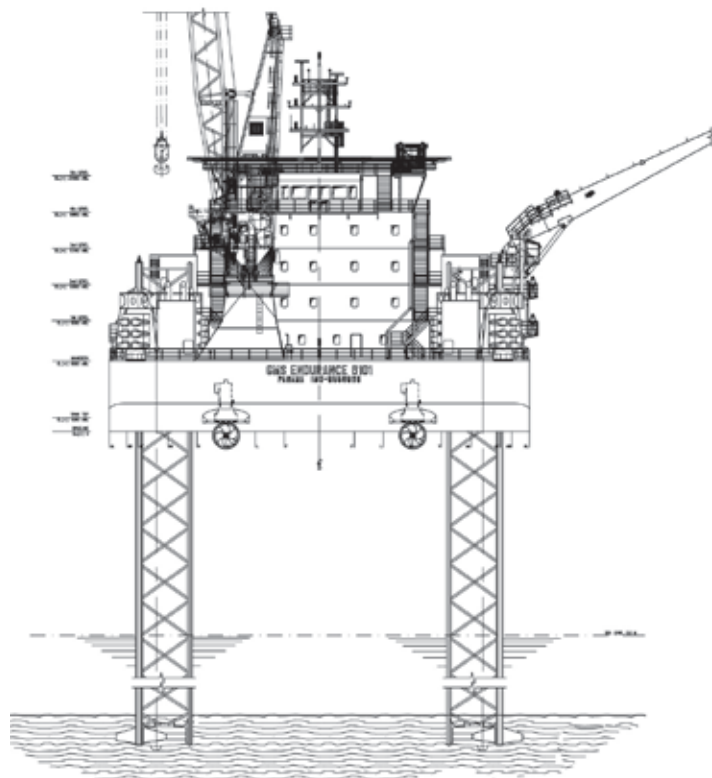

AFT VIEW

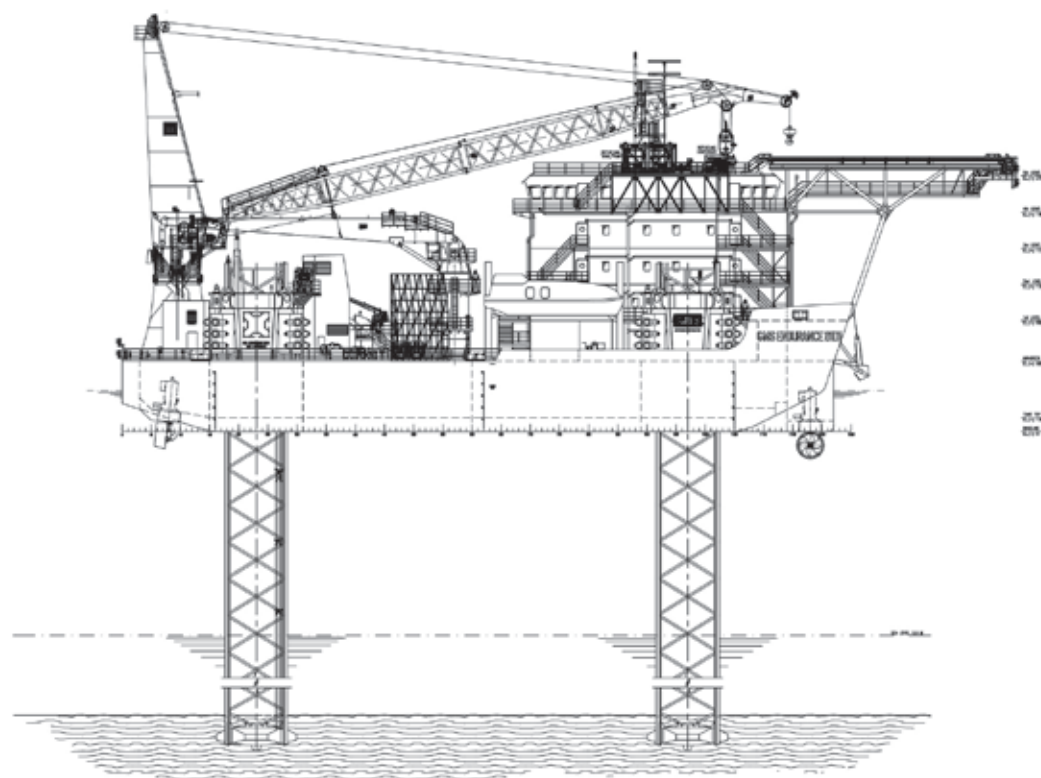

OUTBOARD PROFILE

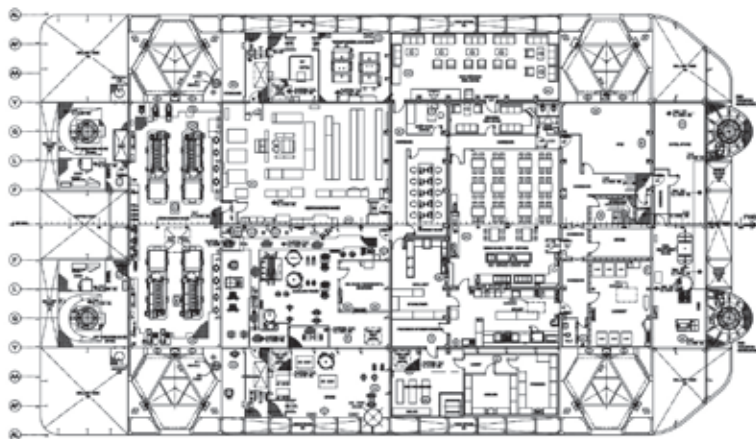

MACHINERY DECK

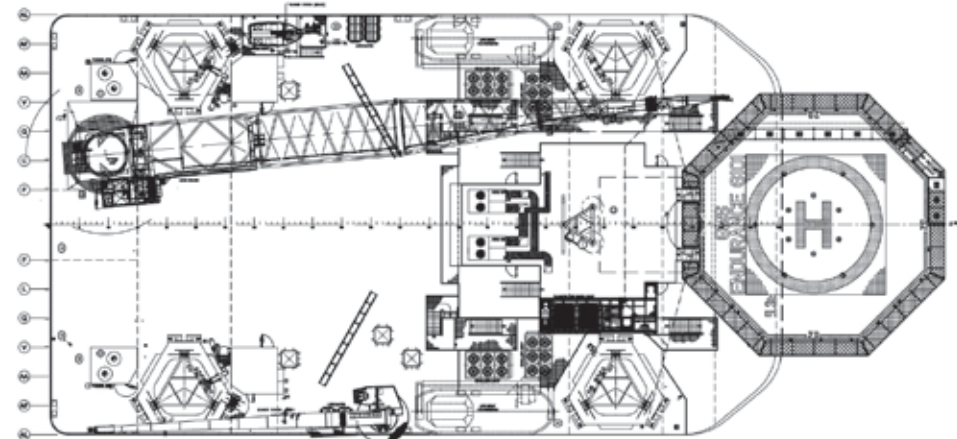

TOP VIEW

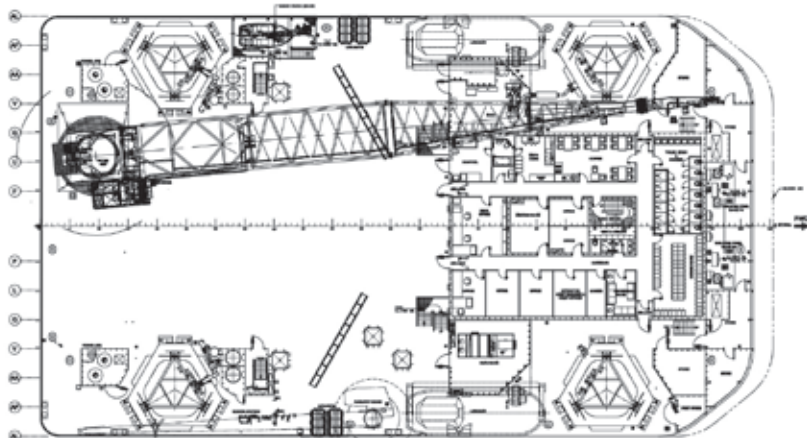

MANDECK
MANDECK ASSOCIATES, P.C.

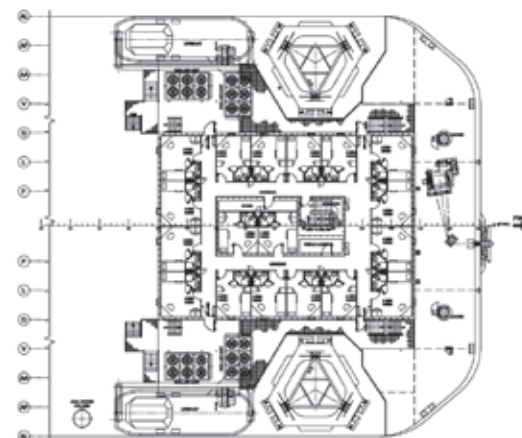

1st LEVEL
PLAYING STOCK ABL.



2nd LEVEL
PLAYING 1200-1400



3rd LEVEL
PLAY @ 1000 A.M.

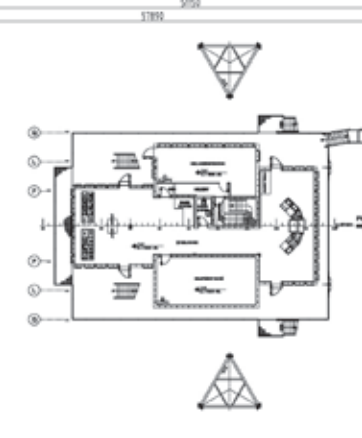

4th LEVEL

